

Yeosu Expo Convention Center

Yeosu Expo Convention Center (Inside of Expo 2012 Yeosu Korea)

1 Bangnamhoe-gil, Yeosu city, Jeollanam-do province

Tel. +82-61-659-2092~4 Fax. +82-61-659-2029

www.expo2012.kr

Guide for
Yeosu Expo Convention Center
Facilities

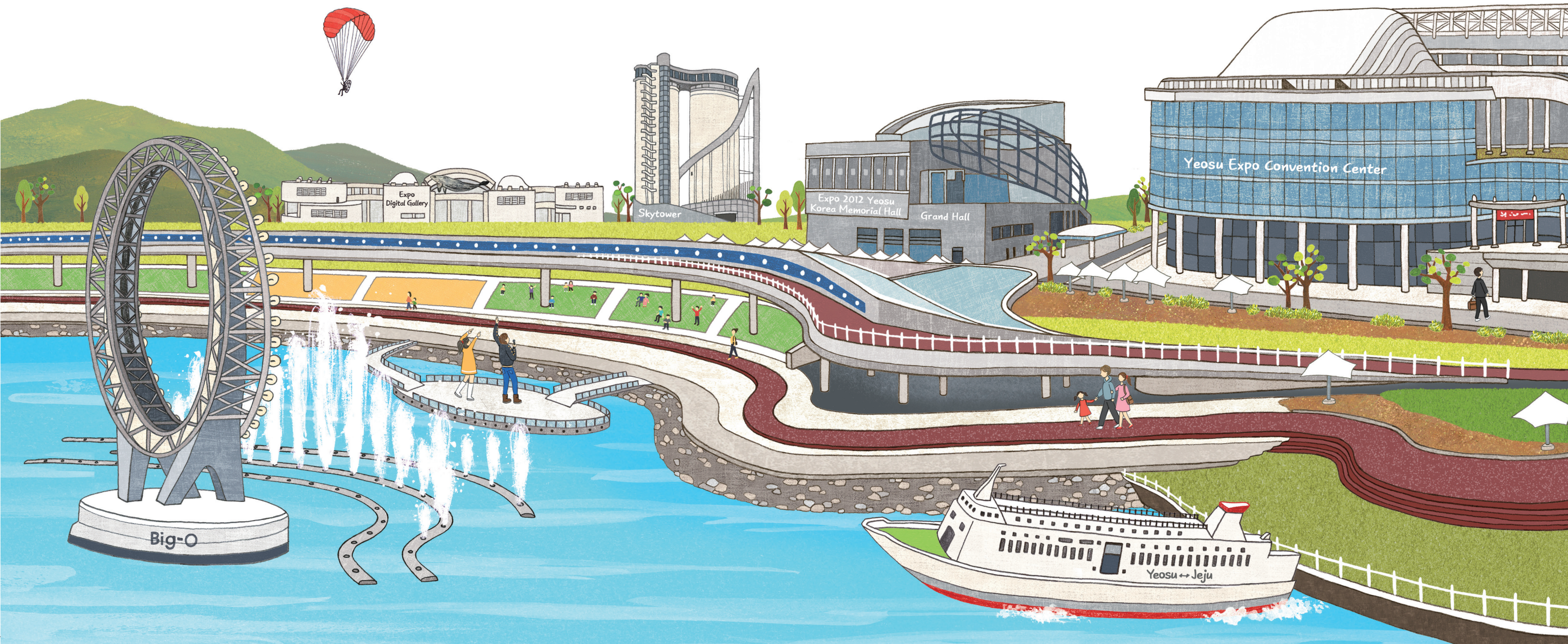

OVERVIEW

Major facilities

Expo Hall, Conference Hall, Seminar Rooms 1-9

Grand Hall, Meeting Rooms 1-3

Exhibition Hall D₁~D₅

Expo Digital Gallery(EDG), Big-O and concert stage on the sea

FLOOR PLANS

Yeosu Expo Convention Center

3F Terrace / Epouser Wedding hall

2F Expo Hall and Lobby



1F Conference Hall and Lobby



B1F Seminar rooms (9)

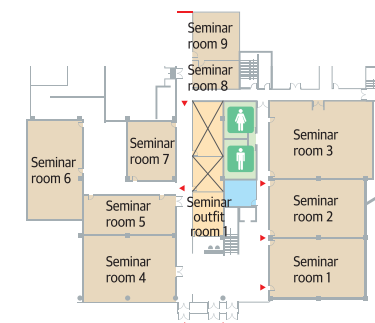

Exhibition Hall D₁~D₅

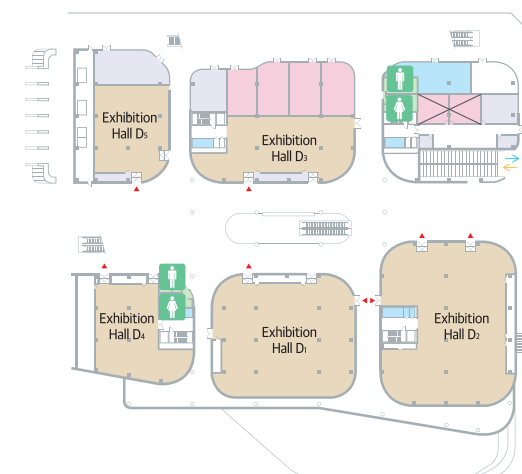

Grand Hall/Meeting Rooms

3F 2012 Yeosu Expo Memorial-Hall

2F Meeting rooms (3)

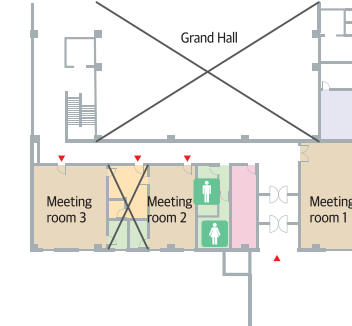

1F Grand Hall

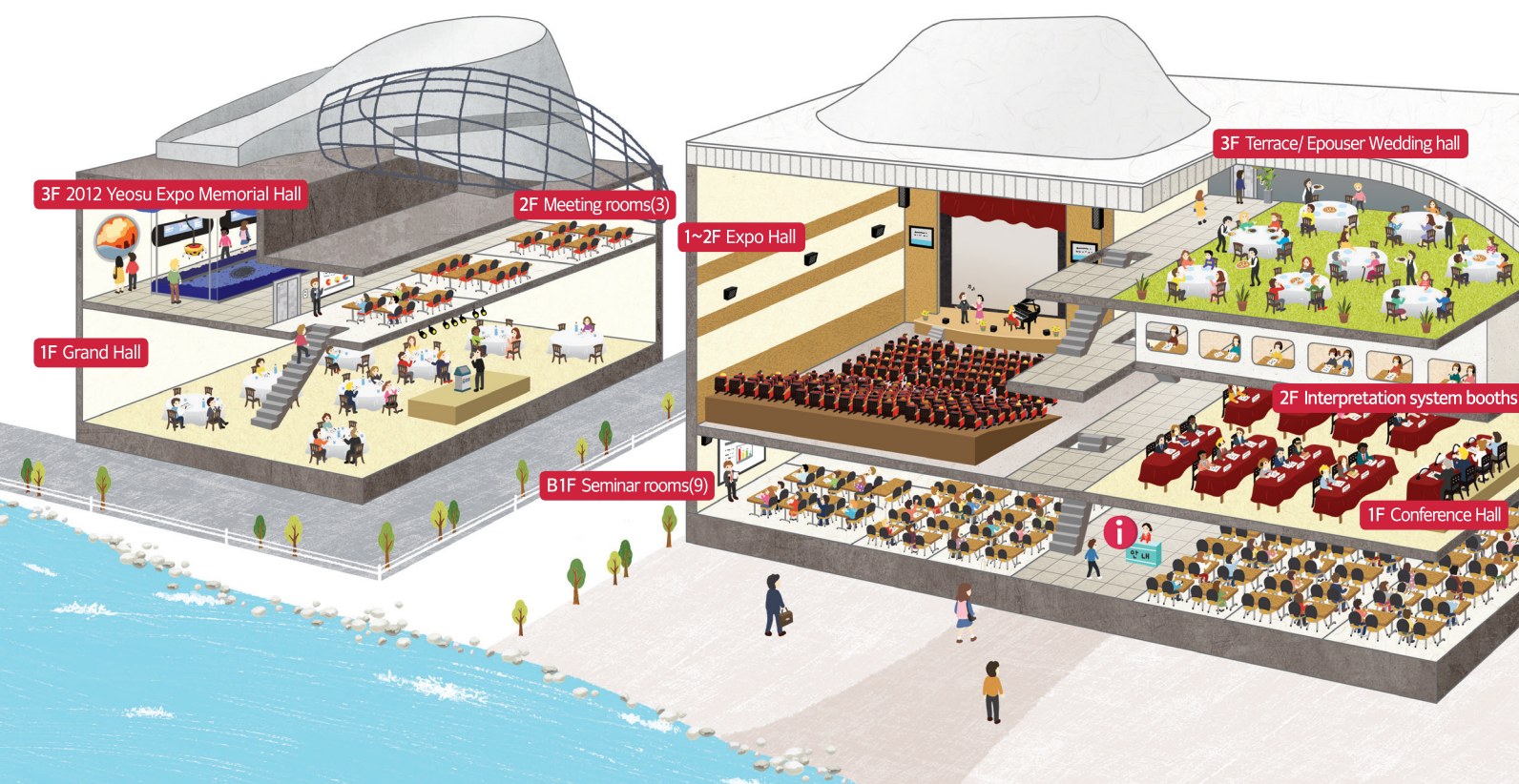

Yeosu Expo Convention Center Bird's eye View

With a wide and beautiful scenery of the southern sea and its excellent accessibility, the convention center equips the latest convention facilities that make it easy to hold conference and exhibition event as well as a new and more secured marine leisure activity facilities in one spot.

Facility Information

- 1 Yeosu Expo Convention Center
- 2 Grand Hall/Meeting rooms
/2012 Yeosu Expo Memorial Hall
- 3 Exhibition Hall D1~D5
- 4 Big-O
- 5 Expo Digital Gallery(EDG)
- 6 Sky-tower
- 7 Aqua Planet Yeosu
- 8 Theme Pavilion
- 9 Expo Square
- 10 Information
- 11 Marine Leisure Sports Experience Center

Parking lot

- P1 A parking lot
- P2 B parking lot
- P3 Aqualium entrance parking lot
- P4 Sky-tower entrance parking lot

Nearby facilities

- A Yeosu Expo International Cruise Terminal
- B Yeosu Expo ferry terminal
- C TheSONO Calm Hotel Yeosu
- D Odongdo Island
- E Yeosu Venezia Hotel And Resort
- F Yeosu Utop-Marina Hotel And Resort

Gates

- G1 Main Gate
- G2 Yeosu-Expo site Gate(KTX)
- G3 Sky-tower Gate
- G4 International Pavilion A/B parking lot Entrance
- G5 International Pavilion A parking lot exit



1F·2F Expo Hall

Grand-scale conference hall / Multi-purpose concert hall

Facility Introduction

Designed as theater-type hall, it is the most suitable place to hold big-scale concert, performance or event easier. With the lobby that gives you a grand sea scenery and many auxiliary facilities, it gives a functional convenience for opening event.

Floor Plan of Expo Hall

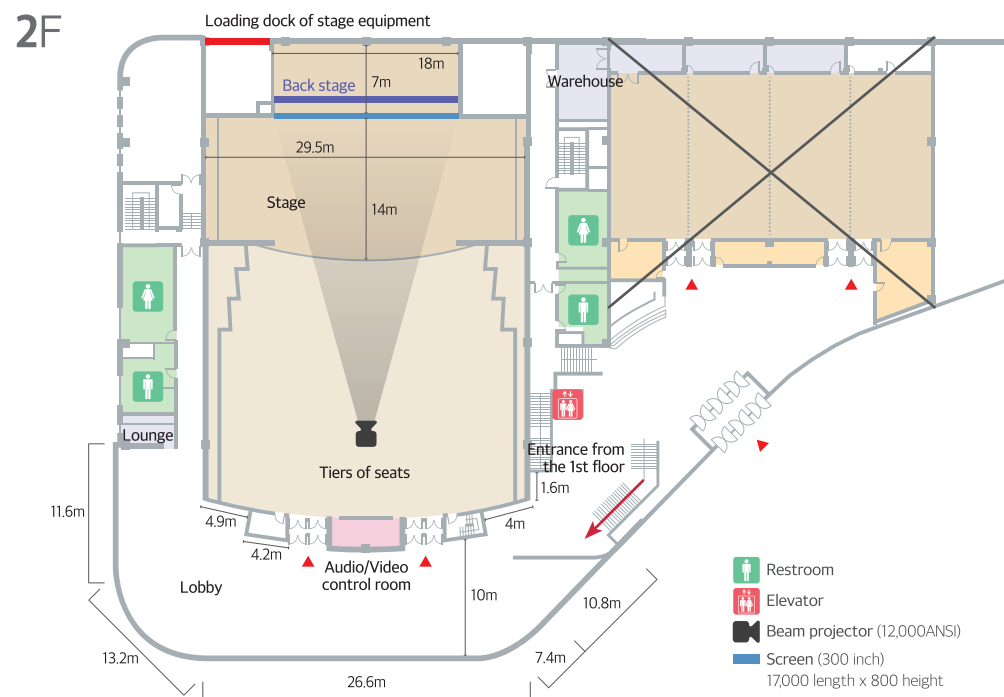

State of facilities and charterage

Floor	Area (m)	Volume and Size (LxWxH) (unit : meter)	Theater-type	Class-type	Banquet-type	Charterage(KRW) / VAT included				
						09:00~12:00	13:00~18:00	19:00~22:00	09:00~18:00	etc.
						Morning	Afternoon	Night-time	A whole day	Charterage rate for art performance (whole day)
Expo Hall	1,180	38 50 8.6	978	-	-	2,541,000	3,267,000	2,178,000	4,477,000	2,239,000
Expo Hall Lobby	757	- - -	A booth capacity 27EA (Based on 3m x 3m)			-	-	-	1,165,780	-



1F Conference Hall

Middle scale conference hall, Sectional meeting room

Facility Introduction

The Conference hall equips simultaneous interpreter booths to provide up to 5 language interpretation services available at once for international conference and events. It is the optimal space that maximizes efficiency as it is dividable for 4 sections.

Floor Plan of Conference Hall

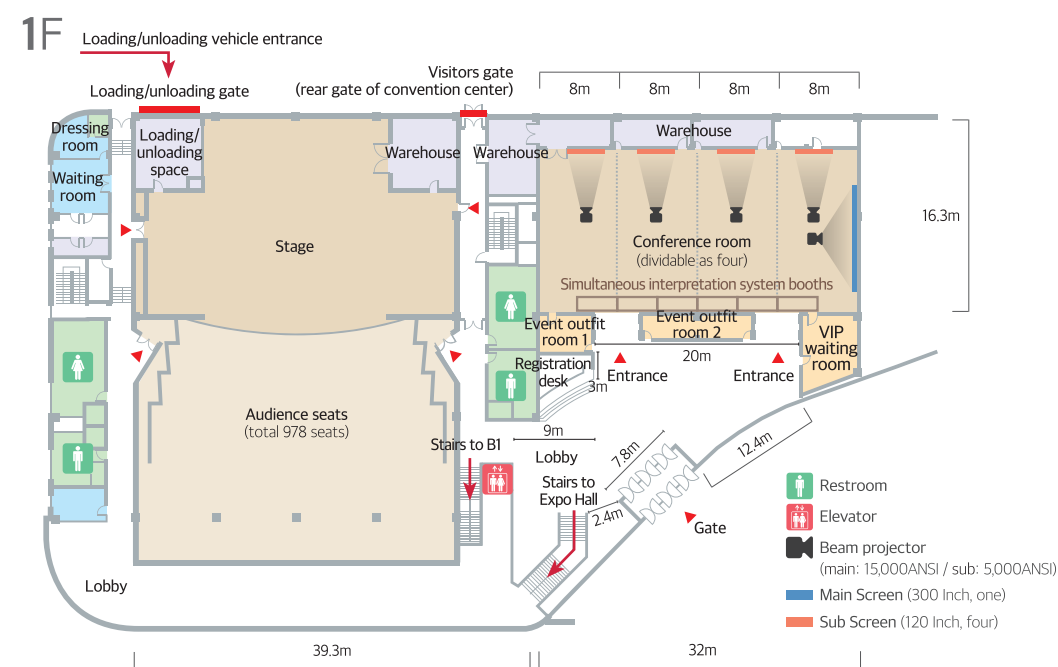

State of facilities and charterage

Floor	Area (m)	Volume and Size (LxWxH) (unit : meter)	Theater-type	Class-type	Banquet-type	Charterage(KRW) / VAT included			
						09:00~12:00	13:00~18:00	19:00~22:00	09:00~18:00
						Morning	Afternoon	Nighttime	A whole day
Conference Hall	546	32 16.3 6	400	250	200	1,331,000	1,694,000	1,452,000	2,420,000
Conference Hall Lobby	984	- - 2.1	A booth capacity 15EA (Based on 3m x 3m)			-	-	-	1,515,360

※ Movable stages : 16 set(1 set : 2L x 1W x 0.8H)

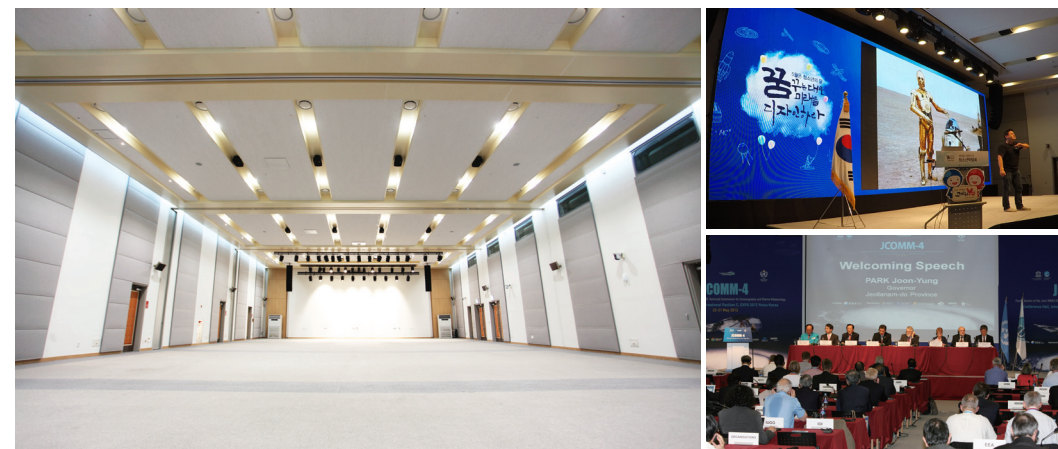

2F Meeting Rooms 1~3

Small meeting rooms

Facility Introduction

As an independent room located in the 2nd floor of Grand Hall, it is a space that equips interior and soundproof facility that help concentrate on the meeting.

※ These meeting rooms are located at the 2nd floor in 2012 Yeosu Expo Memorial Hall.

Floor Plan of Meeting Room



State of facilities and charterage

Floor	Area (m ²)	Volume and Size (LxWxH) (unit : meter)	Theater-type	Class-type	Banquet-type	Charterage(KRW) / VAT included			
						09:00~12:00	13:00~18:00	19:00~22:00	09:00~18:00
						Morning	Afternoon	Nighttime	A whole day
Meeting Room 1	110	7, 8.8, 2.7	80	50	-	218,000	315,000	230,000	460,000
Meeting Room 2	44	4.7, 8.5, 2.8	20	12	-	169,000	206,000	182,000	303,000
Meeting Room 3	69	7, 8.5, 2.8	50	35	-	182,000	218,000	194,000	315,000

※ The meeting room 2 is equipped with a movable screen and beam projector.



Meeting Room 1



Meeting Room 2



Meeting Room 3

Exhibition Hall D₁~D₅ on the 1st floor of International Pavilion D

Exhibition hall

Facility Introduction

The place where 104 countries' contents were displayed became the one that various events, exhibitions and fairs can be held.

Floor Plan of Exhibition Hall D₁~D₅

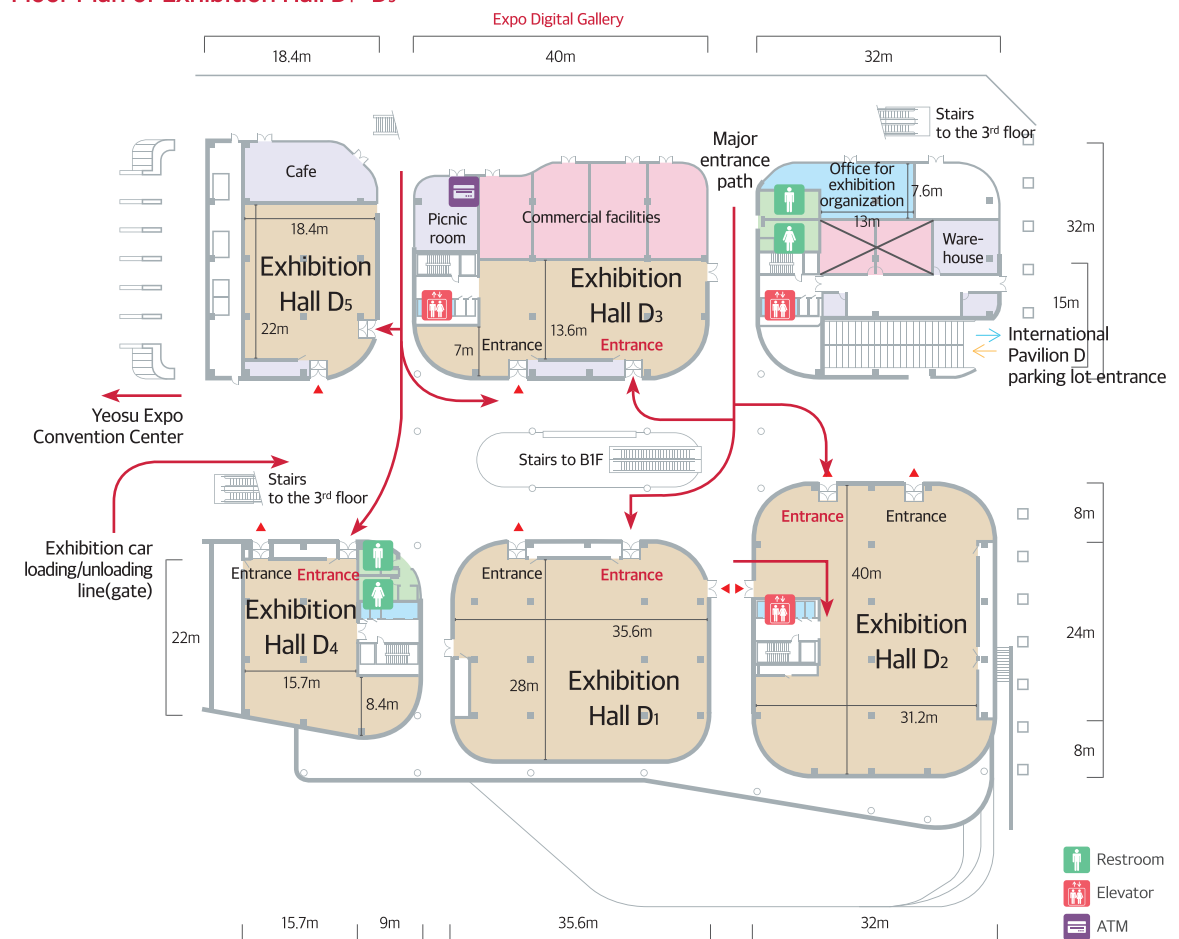

State of facilities and charterage

Floor	Area (m ²)	Volume and Size(Ceiling Height) (LxWxH) (unit : meter)	Charterage(KRW) / VAT included	
			A whole day (09:00~20:00)	
Exhibition Hall D ₁	1,064	35.6, 26, 8	1,030,000 / 49ea(Based on 3m x 3m)	
Exhibition Hall D ₂	1,240	31.2, 40, 8	1,200,000 / 41ea(Based on 3m x 3m)	
Exhibition Hall D ₃	559	15, 40, 8	541,000 / 23ea(Based on 3m x 3m)	
Exhibition Hall D ₄	487	24.7, 22, 8	472,000 / 20ea(Based on 3m x 3m)	
Exhibition Hall D ₅	441	18.4, 22, 8	427,000 / 16ea(Based on 3m x 3m)	

A electricity usage fee is not included.(It depends on your usage.) Also, a booth capacities are flexible.(It depends on the booth arrangement type and size.)



Expo Digital Gallery

Business meeting or Gala dinner show / Large scale exhibitions and fairs

Facility Introduction

As one of 15 business friendly venues in 2016 that the Ministry of Culture, Sports and Tourism has designated, it is a unique venue that can accommodate big-scale gala dinner show or exhibition fair with the LED display on Expo Digital Gallery.

Floor Plan of Expo Digital Gallery

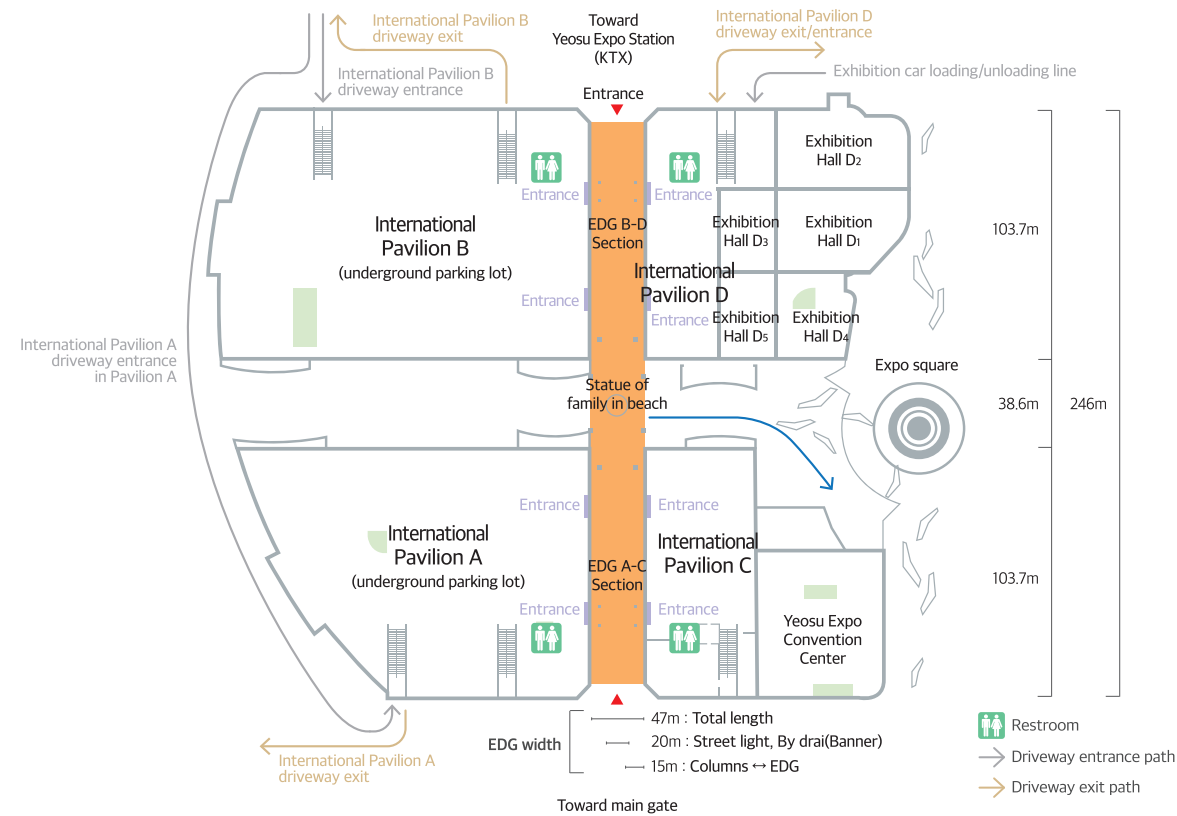

State of facilities and charterage

Floor	Area (m ²)	Volume and Size (LxWxH) (unit : meter)	Charterage(KRW) / VAT included A whole day (09:00~20:00)	Resolution of EDG screen			
				EDG A section		EDG B section	
				Screen1	Screen2	Screen3	Screen4
Expo Digital Gallery	9,000	225 40 22~24.5	5,711,000	1,760×960px	1,770×960px	1,770×960px	1,542×960px



Big-O

Outdoor concert stage, Gala dinner show

Facility Introduction

Big-O show is the landmark of Expo Expo Site, playing multimedia contents with world-class ocean fountain and laser lighting effects. The stage on the sea in front of O structure and audience seats that accommodate up to 3,000 persons make it a special event zone that can hold big scale performance and events.

Floor Plan of Big-O

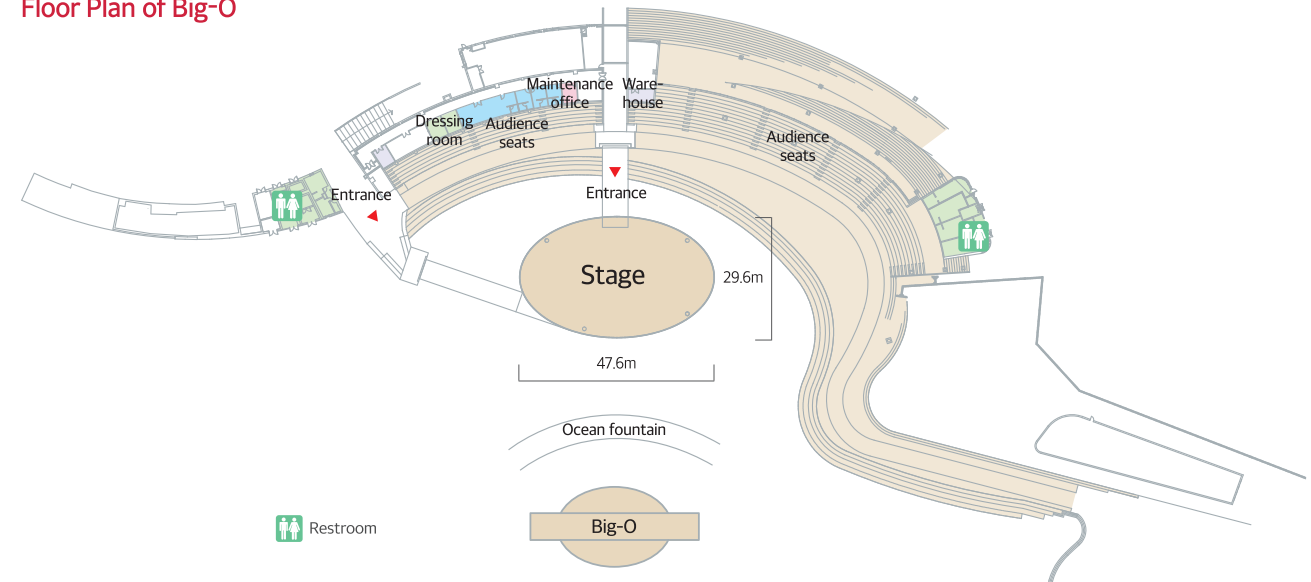

State of facilities and charterage

Floor	Area (m ²)	Volume and Size (LxWxH) (unit : meter)	Charterage(KRW) / VAT included A whole day (09:00~20:00)
			Call the foundation office for the rate
Big-O	No. of seats : 1,800 ~ 3,000 persons (Total capacity : 1,450,000m ²)	diameter of 47.6m / radius of 29.6m No. of seats : 2,200EA	



Accommodation-Tourism Facilities/ Incentives for MICE Event in Yeosu and Jeollanam-do



Accommodation Information

Name of Accommodation	No. of rooms	Auxiliary facilities	Tel	Distance (from the convention center)
TheSONO Calm Hotel Yeosu	311 rooms	Buffet restaurant, sky lounge, outdoor garden, spa and fitness center	061-660-5800	2km
Odongjae Hotel(a korean-style house)	32 rooms	Korean restaurant, korean traditional wedding hall, Hanok stay(Korean house experience), banquet hall	061-650-0300	2km
Hotel Mattieu	44 rooms	Korean restaurant, cafe, sky garden, karaoke room(for group only)	061-662-3131	3km
Hiddenbay Hotel	131 rooms	Restaurant, lounge bar, Huwon therapy, fitness center	061-680-3000	9km
Gyongdo Resort	100 rooms	27 holes golf course, banquet hall, outdoor pool, auto camping site	061-660-1000	9km
U Castle Hotel	72 rooms in hotel/ 14 rooms in condominium Jeollanamdo	Driving range, pension, sauna, spa, futsal court	061-808-5000	25km
Yeosu The Ocean hotel/resort	137 rooms in hotel/ 128 rooms in resort	Golf course, water park, wedding hall, sauna	1588-0377	30km
The Hotel Soo	126 rooms in hotel	Business Center, Korean Restaurant, Meeting rooms, Loop-Top Bar	061-681-1111	5km
Yeosu Venezia Hotel And Resort	340 rooms in hotel	Banquet hall, buffet restaurant, outdoor pool, wedding hall	010-2409-0552	1.5km
Yeosu Utop-Marina Hotel And Resort	389 rooms in hotel	Banquet hall, buffet restaurant, outdoor pool, wedding hall	061-663-2003	1.5km

Accommodation·Tourism Facilities

Name of Accommodation	Charter rate(KRW)/VAT included	Group rates	operating time	The time required	Tel
Big-O Show	P석 22,000 / S석 18,000	Please separate inquiry	19:00 ~ 20:55 *Seasonal price	45 minutes	061-659-2046
Aqua-planet Yeosu	23,000		10:00 ~ 19:00	1 hour ~ 2 hours	061-660-1111
Teddy-bear Museum	12,000		10:00 ~ 19:00	1 hour	061-666-1181
Sky-Tower	2,000		09:00 ~ 18:00	1 hour	061-659-2065
2012 Yeosu Expo Memorial-Hall	3,000		10:00 ~ 20:00	1 hour	061-659-2087
Sky-fly(Zip-line)	15,000		09:00 ~ 18:00	10 minutes	061-666-2626
Yeosu mi-nam cruise	Round trip 18,900		11:00 14:00 16:00 19:30	1 hour 30 minutes	061-641-1000
Yeosu Maritime Cable Car	13,000 ~ 20,000		12,000	09:00 ~ 22:00	Round trip 25 minutes
Ocean Rail Bike	3persons 25,000 / 4persons 30,000	3persons 22,500 / 4persons 27,000	09:00 ~ 17:30	35 minutes	061-652-7882

Incentive Guide for MICE event holding in Yeosu (as of year 2020)

- **Target for incentive**
 - Associations, institutions, corporations and academic societies holding meetings and conferences in Yeosu
 - With more than 150 participants for more than 2 days.
- **Incentive Scale**
 - Limit on incentive : Maximum 20 million KRW per event
- ※ including if
 - MICE event any additional subsidy or financial support is given by Yeosu city/ no lodging guest event or meeting for the purpose of politics, religion, sports, tourism, friendly visit or special lecture session.
- **Contact**
 - MICE support team, Dept. of Expo utilization, Yeosu City Government
061-659-3462-64

Incentive Guide for MICE event holding in Jeollanam-do (as of year 2020)

- | • Target for incentive
- Associations, institutions, corporations and academic societies holding meetings and conferences in Jeollanam-do | |
|---|---|
| Division | Target for incentive |
| International Conference | - Organized or sponsored by international organizations with more than 50 participants for more than 1 days.
- If an organization or organization that is not affiliated with an international organization holds more than 2 days and more than 150 participants and 50 foreigners are attending. |
| Corporate meeting | - For meetings held by academic societies and associations or non-profit seminars(More than 2 times) holds more than 2 days and more than 100 participants. |
| Overseas award tour | - With more than 30 foreigners participants(numbers count based on lodging guests) for more than 1 days. |
| Other meetings | - Special events with a high percentage of foreigners participating in international events and specialized industries |
| • Incentive Scale - Limit on incentive : Maximum 20 million KRW per event
※ excluding if
MICE event any additional subsidy or financial support is given by Jeollanam-do/ no lodging guest event or meeting for the purpose of politics, religion, sports, tourism, friendly visit or special lecture session.
- 50% of the grant can be supported when receiving the incentive in Jeollanam-do Province. | |
| • Contact Jeollanamdo Culture and Tourism Foundation Tel : +82-61-659-3462-64
Fax & Email : +82-61-980-5867 & hanna2@iact.or.kr | |

Road to Yeosu Expo Convention Center



By walk

1. Using **KTX** : Yeosu Expo Station → Enter Gate 3(in front of the station) → Follow **Path 1**(5minutes walking)
2. From **Main Gate** : Enter Main Gate → Follow **Path 2**(2 minutes walking)



By car

- From **B parking lot** : Toward Expo station crossroad → Enter B parking lot gate → Parking → Move to 1F → Follow **path 3**(2 minutes walking)
- From **A parking lot** : Toward Expo station crossroad → Enter toward A parking lot → Parking → Move to 1F → Follow **path 4**(2 minutes walking)
- From **Sky-tower entrance parking lot** : Toward Expo station crossroad → Go straight thru Expo station → Turn left → Enter the Sky parking lot gate → Parking → Follow **path 5**(5 minutes walking)
- From **Aquarium entrance parking lot** : Toward parking lot near Aqua Planet → Parking → Follow **path 6**(7 minutes walking)
- Cars for event** : Only pre-registered cars for event can enter inside Yeosu Expo site → Follow **path 7** → Go and stop nearby event venue
- Exhibition vehicles** : Exhibition Hall D1 ~ D5 users



State of facilities and charterage

Category	Total	International Pavilion A	International Pavilion B	Sky-tower entrance parking lot	Aqualium entrance parking lot	
					Bus	Car
No. of car capacity	2,023	276	500	400	33	700
Fees & Fares	<div>- Cars : 300 KRW per 10 mins/ Max 10,000KRW per day</div> <div>- Bus : 10,000KRW(no time limit/ one-time re-entrance allowed)</div> <div>- Parking fee discount</div> <div>① 50% discount for : cars under 1,000cc, disabled, veterans, clean fuel car(certification mark should be attached on the car), visitors for Big-O show Ticket Holder</div> <div>② Fixed parking fee discount(1,000 KRW per day) : Rental Contractors and correspondents for utilizing Yeosu Expo Convention Center(Exhibitions and performances events are separate)</div>					
Operation hour	everyday 09:00~22:00					